

# FLOS

03.8840.40A White/White

## Light Shadow Fixed Trim 8 Spots Optic Spot NEW

Designed by FLOS Architectural, 2022



Recessed integrated luminaire with 8 LED lighting spots. Remote power supply included (220-240V).

Are you a professional and your project needs consulting and support?

[BOOK AN APPOINTMENT](#)

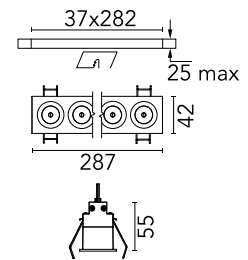

### Main specifications

Mounting	Ceiling recessed
Environments	Indoor dry location
LED type	Power LED
Lamp category	LED
Iicos	No
Number of heads	1
Power (W)	21.6
Source flux (lm)	2280
System flux (lm)	1898

### Physical

Colour	White/White
Trim	Yes
Orientation	Fixed
Recessed depth (mm)	75
Length (mm)	287
Net weight (kg)	0.50
IP internal	20
IP external	55

### Download

[Mounting instructions](#)  PDF

### Photometric Files

[LDT / IES](#)  ZIP

### Technical Drawings

[2D](#)  ZIP

[3D](#)  ZIP

[Bim](#)  ZIP



## Schematic light drawing

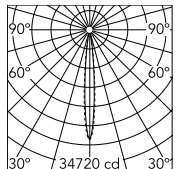

Beam Angle: 10°

h(m)	E(lx)	D(m)
1	34720	0.17
2	8680	0.35
3	3858	0.52
4	2170	0.70
5	1389	0.87

Luminous flux luminaire  
1898 lm (EXTREME CUT OFF)

### Photometric

Lighting type	Direct
Light distribution	Symmetric
CCT (K)	3000
CRI>	90
Beam angle C0-180 (°)	10
Beam angle C90-270 (°)	10

### Electrical

Insulation class	II
Frequency (Hz)	50/60
Main voltage (Vac)	220.00
Alternating current voltage (Vac)	230
LED voltage Vf (Vdc)	24
Driver	Remote included
Dimmable	No
Dimming type	Non Dimmable
Emergency type	No

### Notes

Pre-installation frame not required.